

Rockfon® Spanair® Clip-in

Features & Benefits

- Durable metal panels for interior applications at new or existing 15/16" suspension grid
- Choice between Square Edge panels that fully conceal the grid suspension for a "seamless" look or Reveal Edge panels that semi-conceal to articulate the grid
- Clip-in placement allows for downward accessibility without special tools
- Panels available in a variety of different finishes and perforation options

Applications

- Airports
- Passenger Terminals
- Retail
- Assembly Halls
- Convocation Centers
- Stadiums

*Project – Porsche of The Motor City, in Eastpointe, MI
Product – Rockfon® Spanair® Clip-in Panels*

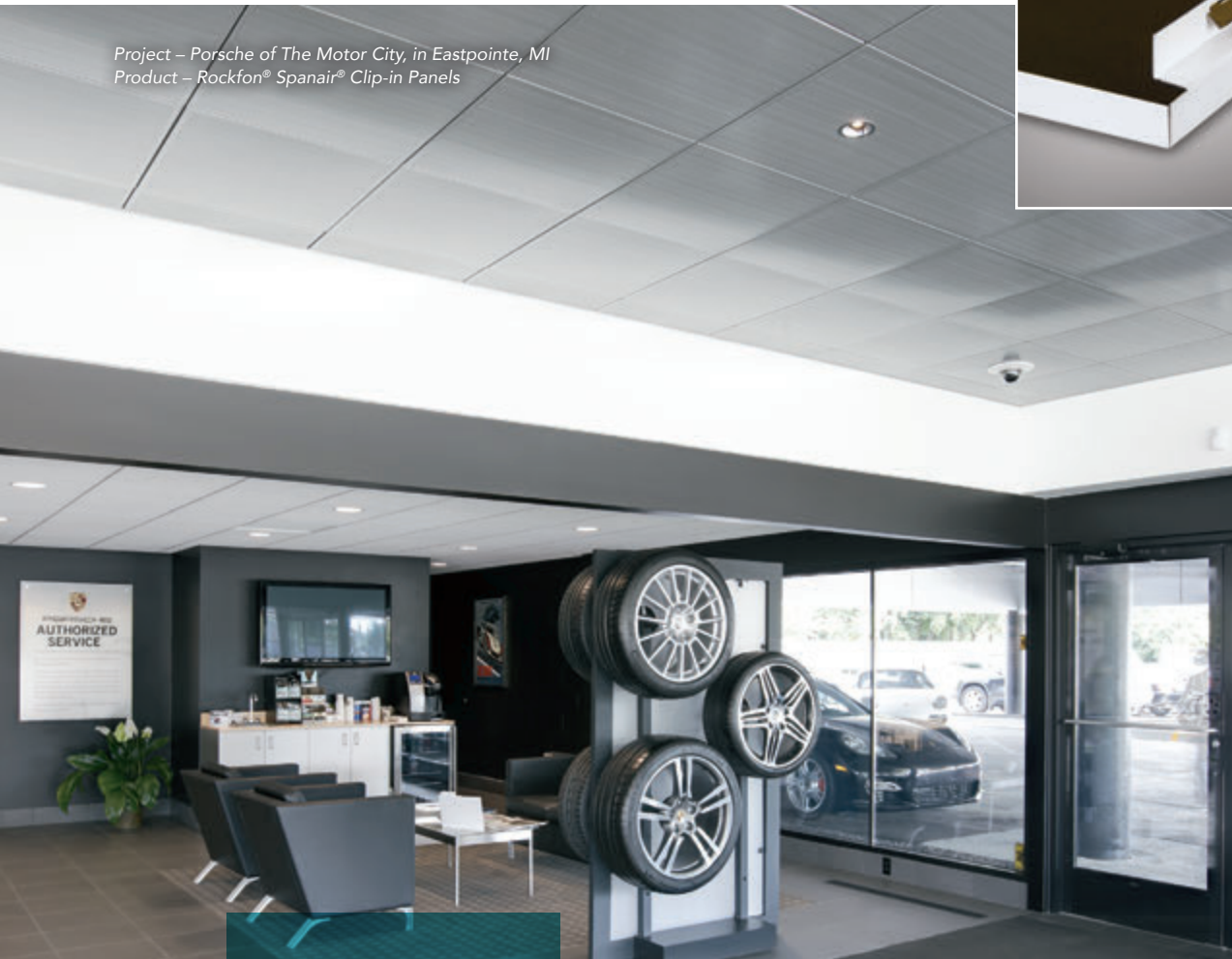
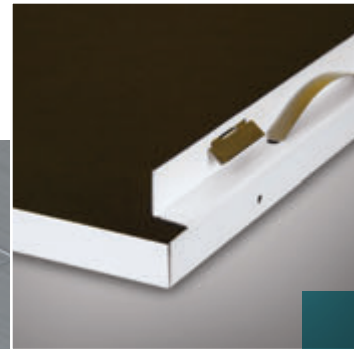

Rockfon® Spanair® Clip-in

LEED® V4 HIGHLIGHTS

Materials and Resources (MR)

Waste Management Planning	✓
Interiors Life Cycle Impact Reduction	✓
Environmental Product Declarations	✓
Sourcing of Raw Materials	✓
Material Ingredients	-
Waste Management	✓

Indoor Environmental Quality (EQ)

Low-Emitting Materials	✓
Interior Lighting	-
Acoustic Performance	✓

Recycled Content: up to 85%

Product Code Example: **252589:SPAN:SCIS:24x24:AA:44:.32AL**

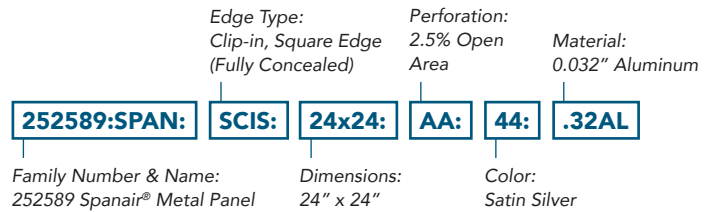

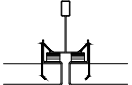
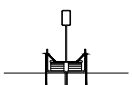
Family Number & Name	Edge Type	Dimensions	Perforations* (% open area)	Material	NRC	Fire Class	Light Reflectance	Low VOC
252589:SPAN: Spanair® Metal Panel	SCIR: Clip-in Reveal Edge (Semi-Concealed) 	24x24: 24" x 24" 24x48: 24" x 48"	<u>Standard</u> SOLID: 0% D: 16.2% E: 20.8% J: 58.2% Q: 70% R: 11.1% V: 4.9% AA: 2.5%	.32AL: 0.032" Aluminum▲	up to 0.90***	A	-	✓
	SCIS: Clip-in Square Edge (Fully Concealed) 	24x24: 24" x 24" 24x48: 24" x 48"	<u>Premium</u> see footnote * <u>Custom</u> CUST: **					

* See the Rockfon Perforations Brochure for graphic representations of the perforations listed and the complete offering of Premium Perforations available.

** For designer specified Perforation, contact Rockfon Technical Services at 1-800-323-7164 or techservices@rockfon.com.

*** NRC values are dependent on perforation patterns, plenum depth and acoustical backer options. Contact Rockfon Technical Services for more information at 1-800-323-7164 or techservices@rockfon.com.

▲ See color chart footnote for more information.

Note:

- Acoutex™ Backer standard with perforated panel.
- Perforated panel available without Acoutex.
- This system is not approved for exterior use.

Choose from the above product options to build your product code

Family Number & Name	Edge Type	Dimensions	Perforation	Color*	Material
252589:SPAN:					.32AL

* Select one of our many color options, located on page 3

Standard colors:



01 White



08 Black



44 Satin Silver



888
Winchester
Grey

Premium colors:



Color-all



Custom
(color match)

Metallic colors:

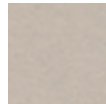

795
Champagne
Metallic



796
Beige
Metallic



797
Iron Glimmer
Metallic



798
Copper
Metallic

Metalwood® Woodgrain Finishes[▲]:



650R
Maple**



651R
Cherry**



652R
Pumpkin
Maple**



653R Oak**



654R Karri**



655R
Bamboo**

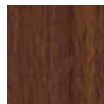

656R
Walnut**



401 Maple*



402 Oak*



403 Cherry*



404 Pumpkin
Maple*



405 Karri*



406 Walnut*

Woodscenes® Painted Finishes[†]:



800
Lazy Maple



801
Aged Teak



803
Burnished
Cherry



804
Sleek Cherry



805
Weathered Oak

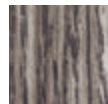

806
Barnwood
Grey

* Coordinating solid color to match Metalwood Woodgrain Finishes.

** Metalwood Woodgrain Finishes not available for Rockfon Infinity™ or Spanair Suspension; use coordinating solid color. See footnote *.

▲ Metalwood Woodgrain Finishes are a 0.008" vinyl laminate that replicate real wood; variations in color and pattern will occur. For final panel thickness information contact Rockfon Technical Services at 1-800-323-7164 or techservices@rockfon.com. For interior use only.

† Woodscenes Painted Finishes are a decorative powder coat finish that replicate real wood; variations in color and pattern will occur.

Note:

- Metalwood and Woodscenes grain direction is parallel to the length of the panel.

- See rockfon.com for more information on color options.

Colors shown are reproduced as close as possible to actual product color within the limitations of printing technology. Color chips are available upon request and should be reviewed before making a final selection. Variations in color matches of system components to ceiling panels can result from slight differences in texture, room lighting, painting process and subjectivity of observers.

Spanair Clip-in Suspension

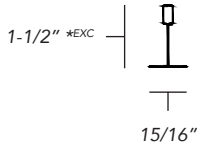
Detail	Product Number	Duty Rating	Length	Slotting	Spacing	Finish
 <p>1-1/2" *EXC</p> <p>15/16"</p>	Main Runner*					
	10.00.250	Intermediate Duty (ID)	144"	6" O.C.	48" O.C.	see footnote **
	10.00.200	Heavy Duty (HD)				
	Cross Tee (Stab-in, Butt Cut)					
	10.01.209	NA ¹	48"	12" O.C.	48" O.C.	see footnote **
	10.01.229		24"	-		
	Cross Tee (Stab-in, Override)*					
	10.01.210	NA ¹	48"	12" O.C.	48" O.C.	see footnote **
	10.01.202*EXC		24"	-		

* Suspension system for Spanair based on Chicago Metallic® Ceiling Suspension. Reference ICC-ES Evaluation Report ESR-2631 for testing information.

** Available in Standard, Premium, Metallic and Woodscenes finishes.

¹ Not Applicable - Duty rating applies only to main runners with a 4-ft span.

Spanair Clip-in Perimeter Trim

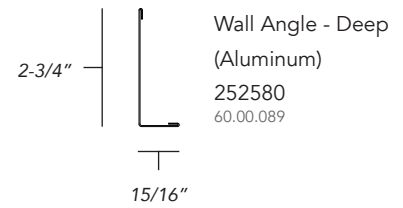
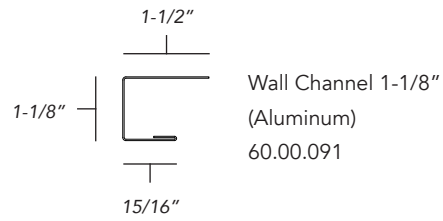
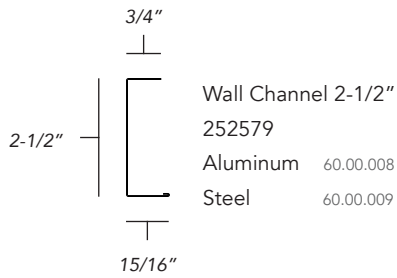

Note - Wall Angle and Wall Channel:

- Standard, Premium, Metallic, Metalwood and Woodscenes finishes available.
- Reflective and anodized finishes available - one side only.

Note - Wall Angle (Deep):

- Standard, Premium, Metallic, Metalwood and Woodscenes finishes available - one side only.
- For detail information, contact Rockfon Technical Services at 1-800-323-7164 or techservices@rockfon.com.

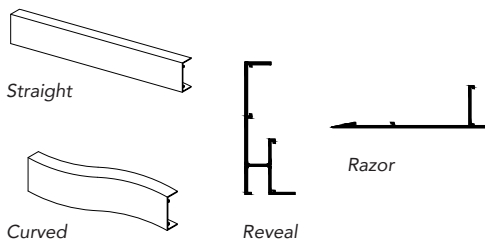

Perimeter Trim

(Rockfon Infinity)

(see Infinity data sheet)

Infinity Engineered Straight Profile

Infinity Engineered Curved Profile

Infinity Standard Straight Profile

Infinity R (Reveal) Edge Profile

Infinity Z (Razor) Edge Profile

Note:

- See Infinity Data Sheet for finish options.

Spanair Clip-in System Accessories



Hold Down Insert
(for Wall Channel 2-1/2")
(2-7/16" height; 3/4" faces)

Aluminum

11" length 249678
60.00.033

22" length 249679
60.00.034

Steel (galvanized)

11" length 249676
60.00.031

22" length 249677
60.00.032

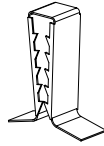

Hold Down Clip
(Metal - Black Oxide)
264683
63.26.200

Note:
- For panels with minimum open area

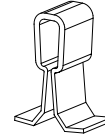

Hold Down Clip
(Clear Plastic)
250382
8886.00

Note:
- For panels with maximum open area

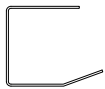

Hold Down Insert
(for Wall Channel 1-1/8")
(15/16" height; 7/8" top face
& 11/16" bottom face)

Aluminum

22" length 249680
60.00.099

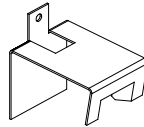

Perimeter Clip
(Galvanized)
251952
1499.00

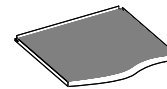

Acoustical Pads
(Poly-Wrapped Fiberglass)
(Black Plastic Wrap)

24" x 24" x 1" 250505
58.01.059.008

24" x 24" x 1-1/2" 250509
58.01.064.008

24" x 48" x 1" 250507
58.01.061.008

24" x 48" x 1-1/2" 250508
58.01.063.008

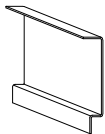

Infinity Attachment Bracket
(Aluminum)
448

Note:
- For Infinity Attachment Bracket detail information,
contact Rockfon Technical Services at 1-800-323-7164
or techservices@rockfon.com.

Spanair Clip-in Standard Details

System Depth

- Panel at Suspension

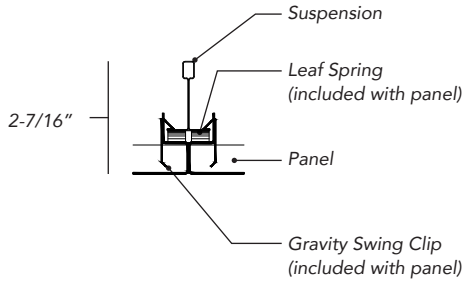

Wall Channel

- New Installation

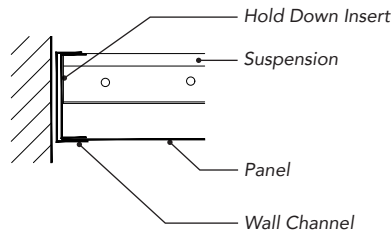

Wall Channel

- Existing Installation

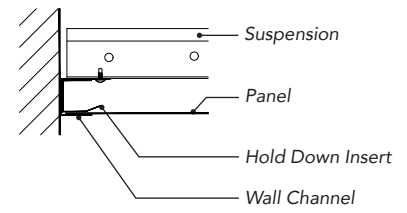

Note: Verify existing suspension is square before installation of Spanair Clip-in Panels.

Rockfon Infinity Perimeter Trim

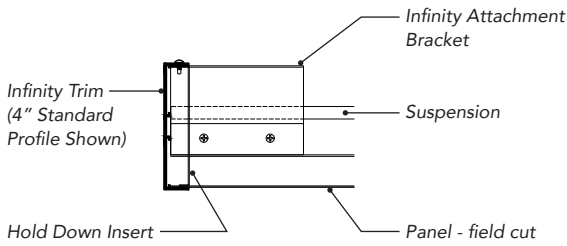

Clip-in panel attachment components

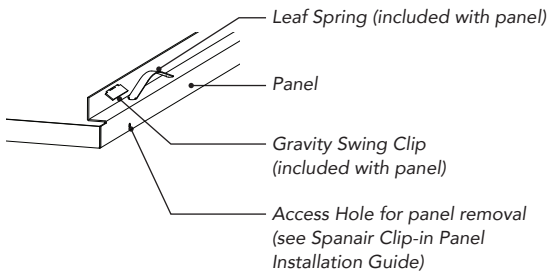

Clip-in panel at Suspension

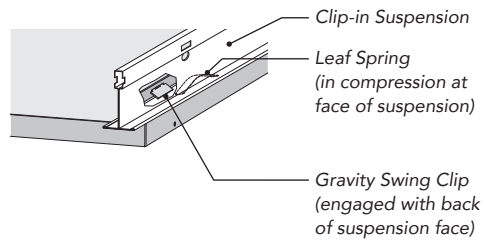

Spanair Clip-in System Detail

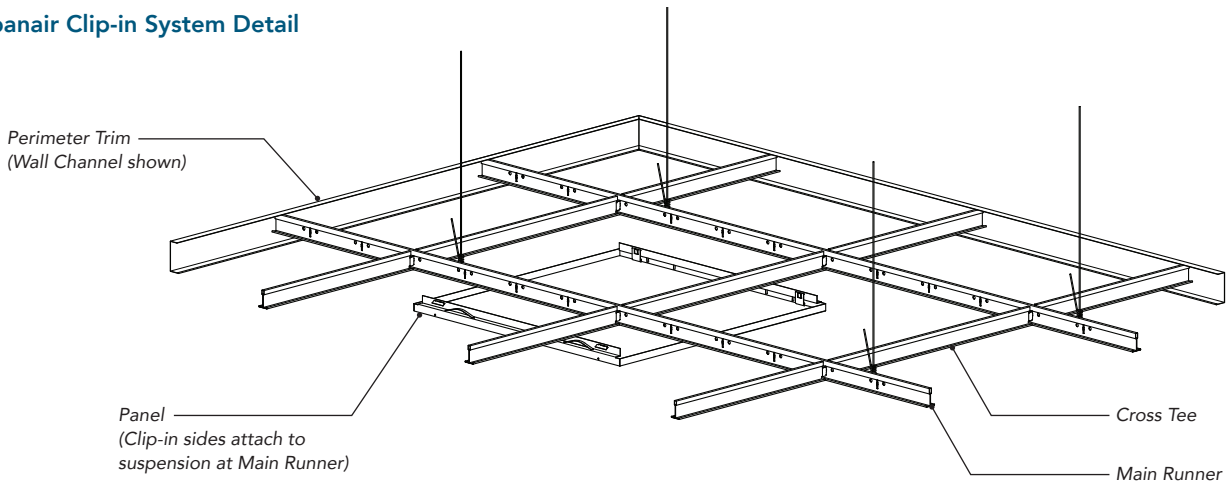



Material

0.032" Aluminum



Fire Performance

Surface burning characteristics:
UL723 (ASTM E84)
Flame Spread Index: 0
Smoke Developed Index
(UL Labeled): 0



Hygiene

Metal provides no sustenance
to microorganisms



Warranty

1-Year Limited
Product Warranty.
See rockfon.com



Environment

- Up to 85% recycled content
- 100% locally recyclable



Cleaning

- Damp Cloth

080819

Rockfon

4849 S. Austin Ave.
Chicago, IL 60638 USA